

# Building Profile

## Alabama Site Selection Database

### DC-2 Building

City: Monroeville    County: Monroe



#### General Building Data

|                                |                             |
|--------------------------------|-----------------------------|
| <b>Total Size</b>              | 230,000 sq.ft.              |
| <b>Space Available</b>         | 230,000 sq.ft.              |
| <b>Multi-tenant</b>            | No                          |
| <b>Building Dimensions</b>     |                             |
| <b>Number of Buildings</b>     |                             |
| <b>Number of Floors</b>        |                             |
| <b>Largest Production Area</b> |                             |
| <b>Office Area</b>             | 15,200 sq.ft.               |
| <b>Building Expandable</b>     |                             |
| <b>Expandable to</b>           |                             |
| <b>Floor Thickness</b>         |                             |
| <b>Total Acreage</b>           | 16                          |
| <b>Additional Available</b>    | Yes                         |
| <b>Ceiling Height</b>          | Eave: 15 ft.<br>Max: 25 ft. |

|                    |                   |
|--------------------|-------------------|
| <b>Bay Spacing</b> | Length:<br>Width: |
|--------------------|-------------------|

#### Air Conditioned

**Heated**

|               |  |
|---------------|--|
| <b>Cranes</b> | Number of Cranes:<br>Capacity of Largest:<br>Under Hook: |
|---------------|--|

#### Truck Docks

|  |                          |
|--|--------------------------|
|  | Dock Level:<br>Drive In: |
|--|--------------------------|

#### Year Built

#### Last Expansion

#### Refrigerated Area

#### USDA Approved

#### Sprinklers

#### Construction Material

|  |                        |
|--|------------------------|
|  | Primary:<br>Secondary: |
|--|------------------------|

#### Parking Paved

#### Number of Cars

#### Zoning

#### Previous Use

#### Previous Use Description

|                                       |                |
|---------------------------------------|----------------|
| <b>Building Id: 5846</b>              |                |
| <b>Street Address</b>                 | 78 Plant Drive |
| <b>Nearest City</b>                   | Monroeville    |
| <b>Within City Limits</b>             | Yes            |
| <b>Zip Code</b>                       | 36460          |
| <b>Latitude</b>                       |                |
| <b>Longitude</b>                      |                |
| <b>Located in Industrial Park</b>     | No             |
| <b>Park Name</b>                      |                |
| <b>Within Enterprise Zone</b>         |                |
| <b>Within Favored Geographic Area</b> |                |
| <b>Within Renewal Community</b>       |                |

#### Transportation

|                     |   |
|---------------------|---|
| <b>Rail Service</b> | Provider:<br>Track Status: Not Specified<br>Provider #2:<br>Track Status: Not Specified |
|---------------------|---|

#### Waterway

|                                    |   |
|------------------------------------|---|
| <b>Nearest Commercial Air City</b> | Dock Facility: Not Specified<br>Mobile, AL<br>Miles to Nearest Service: |
|------------------------------------|---|

#### Highways

| Highway Type    | Highway Name | Miles to Access | Four Lane |
|-----------------|--------------|-----------------|-----------|
| Federal Highway | 84           | 1               | No        |
| Alabama Highway | 21           | 0               | Yes       |

# Building Profile

## Alabama Site Selection Database

### DC-2 Building

City: Monroeville

County: Monroe

#### Utilities

##### Natural Gas

Provider: South Alabama Gas  
Status: Not Specified  
Size of Main:  
Main PSI:

##### Electricity

Provider(s): Alabama Power Company  
Status: Not Specified  
Amps:  
Phase:  
Voltage:

##### Water

Provider: City of Monroeville  
Status: Not Specified  
Size of Main:

##### Telecommunications

Service Provider: Frontier Communications  
Fiber Optics:  
Redundancy:  
xDSL Available:

##### Sewer

Provider: City of Monroeville  
Status: Not Specified  
Size of Main:

#### Price

##### Base Rent (Annual)

##### Base Rent

##### Sale Price

\$2,990,000.00  
Total

##### Negotiable

##### Date Quoted

Sep 20, 2010

##### Price Comments

#### General Comments

*Building information is current as of 9/20/10*

# Building Profile

## Alabama Site Selection Database

### DC-2 Building

City: Monroeville

County: Monroe



This information has been secured from sources we believe to be reliable; however, we make no representation or warranties, expressed or implied, as to the accuracy of the information.

Economic Development Partnership of Alabama  
[www.edpa.org](http://www.edpa.org)

# Building Profile

## Alabama Site Selection Database

### DC-2 Building

City: Monroeville

County: Monroe

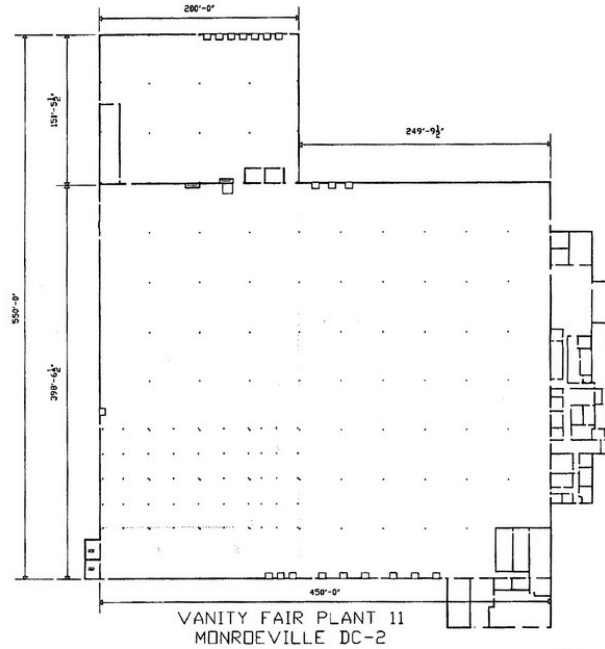

This information has been secured from sources we believe to be reliable; however, we make no representation or warranties, expressed or implied, as to the accuracy of the information.

Economic Development Partnership of Alabama  
[www.edpa.org](http://www.edpa.org)

# Building Profile

## Alabama Site Selection Database

### DC-2 Building

City: Monroeville

County: Monroe



This information has been secured from sources we believe to be reliable; however, we make no representation or warranties, expressed or implied, as to the accuracy of the information.

Economic Development Partnership of Alabama  
[www.edpa.org](http://www.edpa.org)