

Site Profile

Alabama Site Selection Database

North Jackson Indus. Property

City: Jackson

County: Clarke



Site Id: 4031
Street Address: US Highway 43, North of Jackson

Nearest City	Jackson
Within City Limits	No
Zip Code	36545
Latitude	31.5747
Longitude	-87.8812
Located in Industrial Park	No
Park Name	
Within Enterprise Zone	No
Within Favored Geographic Area	Yes
Within Renewal Community	No

Transportation

Rail Service	Provider: Track Status: Not Available Provider #2: Track Status:
Navigable Waterway	Tombigbee River Dock Facility: Port 11 to 25 miles
Nearest Commercial Air City	Mobile, AL Miles to Nearest Service: 65

Highways

Highway Type	Highway Name	Miles to Access	Four Lane
Interstate	I-10	68.0	
Interstate	I-59	94.0	
Interstate	I-65	55.0	
Federal Highway	43	0.0	Yes
Federal Highway	84	11.0	Yes

Price
Sale Price: \$5,000.00 per acre

Land Lease Rate (Annual)

Negotiable? Yes
Date Quoted: Aug 4, 2008

Price Comments: Purchase price is negotiable based on the number of permanent new jobs created.

General Site Data

Total Acres	53
Available Acres	25
Additional Available	Yes
Largest Tract	15
Smallest Tract	10
Protective Covenants	No
Phase 1 Environmental	No
Preliminary Geotechnical:	No
Topography	Flat
Preliminary Wetlands	No
Assessment:	
Ecological Review:	No
Cultural Resources Review:	No
Zoning	None
Previous Use	Forest
Previous Use Description	Timberland

Utilities

Natural Gas	Provider: Clarke-Mobile Gas District Status: Existing Connection Size of Main: Main PSI:
Water	Provider: Jackson Water Works Status: Existing Connection Size of Main:
Sewer	Provider: Septic Tank Status: Existing Connection Size of Main:
Electricity	Provider #1: Alabama Power Company Status: Existing Connection Service to Property: Yes (Distribution): Transmission: Yes Provider #2:
Telecommunications	Provider: AT&T Fiber Optics: Yes Redundancy: Yes xDSL Available:

Site Profile

Alabama Site Selection Database

North Jackson Indus. Property

City: Jackson

County: Clarke

General Comments

Owned by the County Industrial Board. Dual septic field tanks provide sewer.

Site information is current as of 8/4/08



This information has been secured from sources we believe to be reliable; however, we make no representation or warranties, expressed or implied, as to the accuracy of the information.

Economic Development Partnership of Alabama
www.advantagealabama.com

Site Profile

Alabama Site Selection Database

North Jackson Indus. Property

City: Jackson

County: Clarke

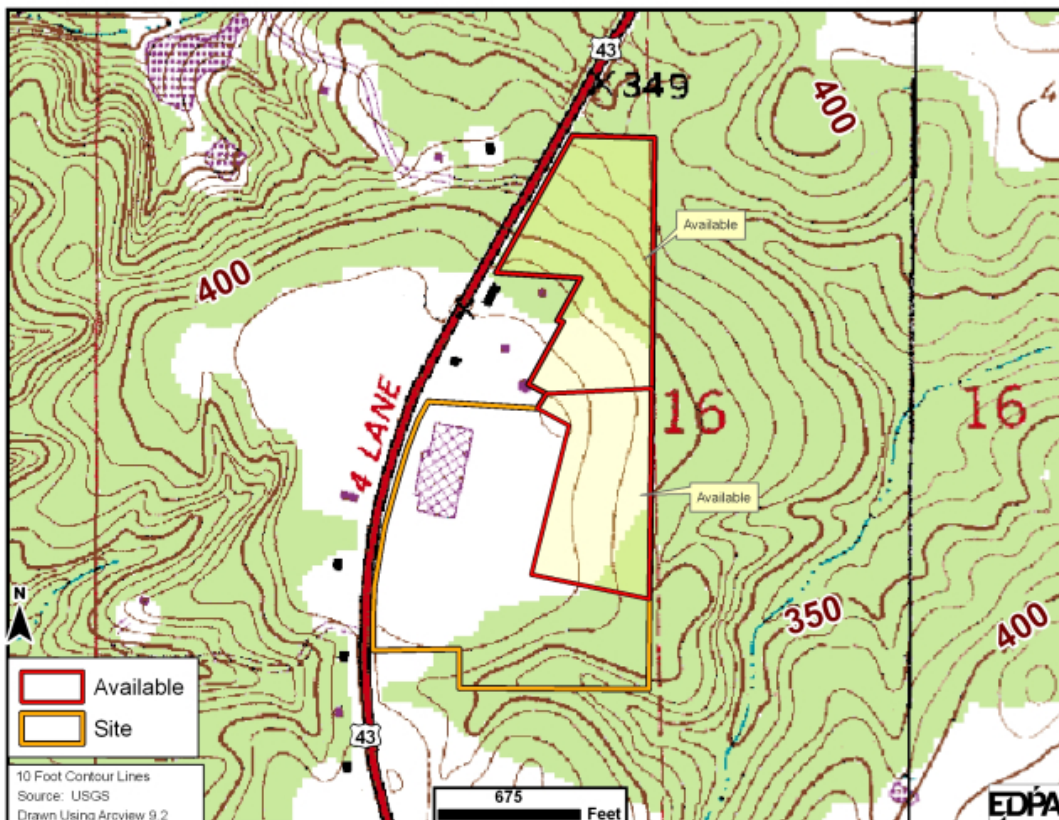
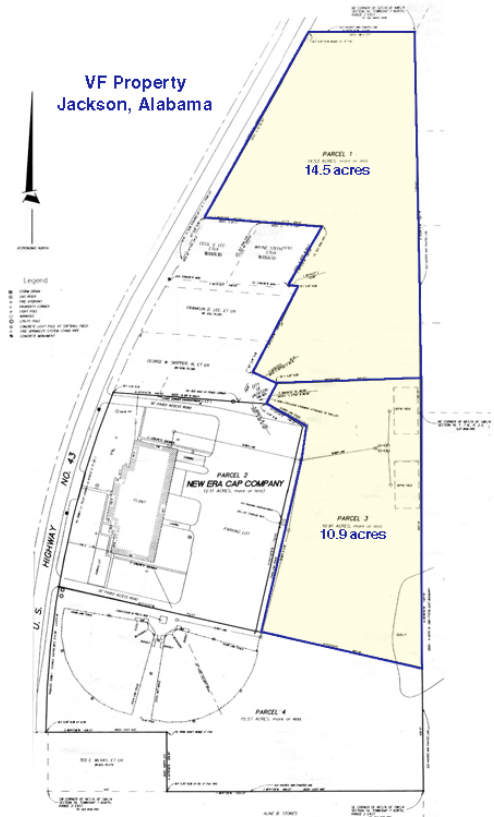

This information has been secured from sources we believe to be reliable; however, we make no representation or warranties, expressed or implied, as to the accuracy of the information.

Economic Development Partnership of Alabama
www.advantagealabama.com

Site Profile

Alabama Site Selection Database

North Jackson Indus. Property

City: Jackson

County: Clarke

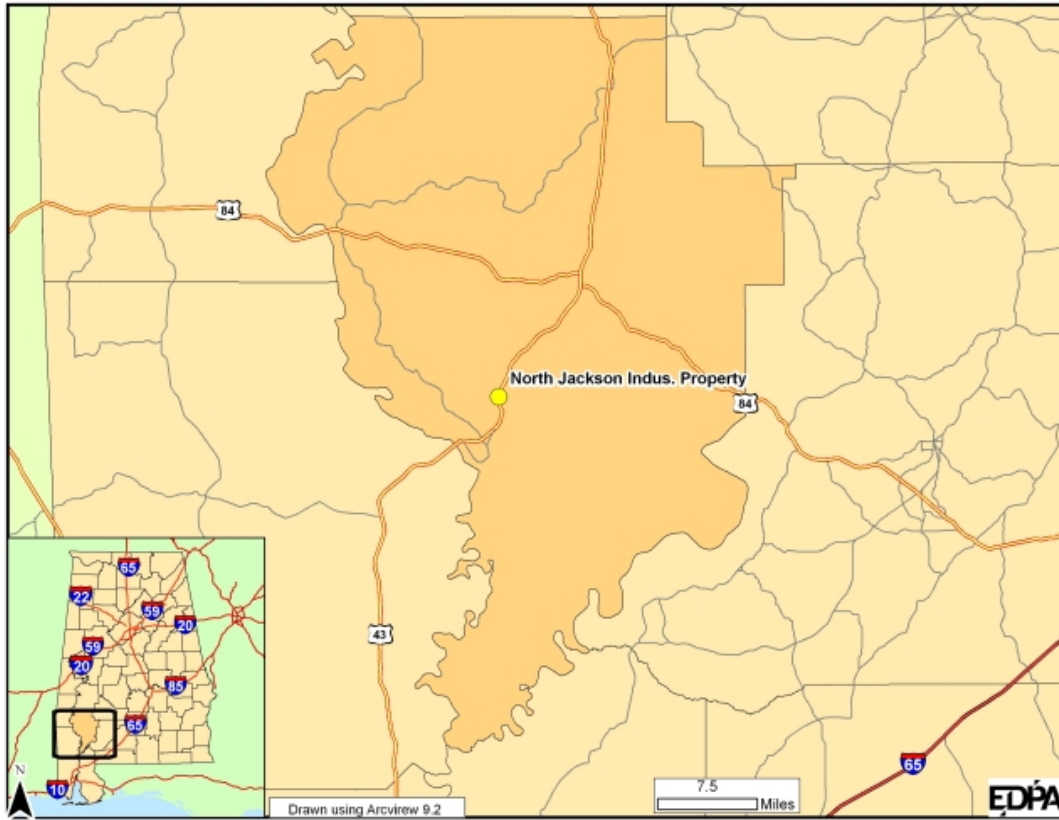

This information has been secured from sources we believe to be reliable; however, we make no representation or warranties, expressed or implied, as to the accuracy of the information.

Economic Development Partnership of Alabama
www.advantagealabama.com